

(2) 4" FF FLANGE
150 lb ANSI
STANDARD
BOLT PATTERN

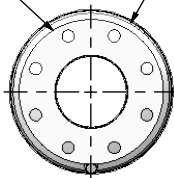

Ø 10.000
SHELL
I.D.

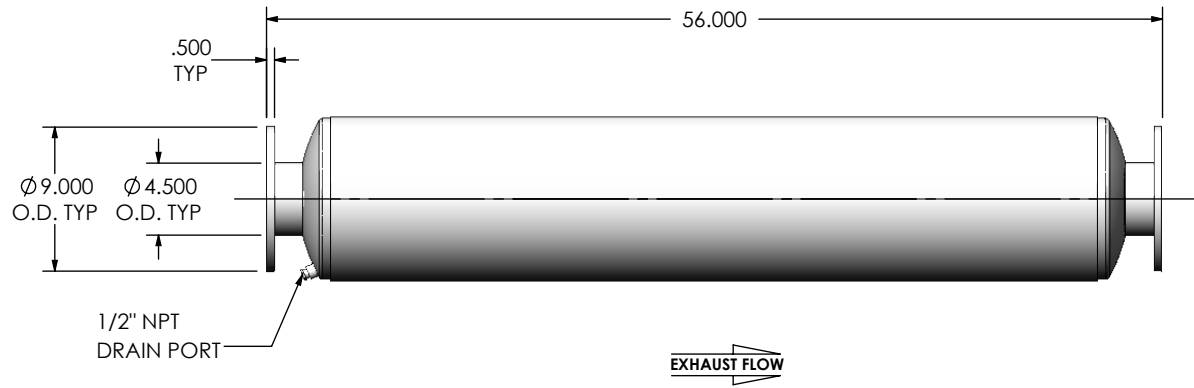

NOTES:

- DO NOT USE EQUIPMENT TO SUPPORT OTHER PARTS OF THE EXHAUST SYSTEM WITHOUT PROPER REINFORCEMENT

MATERIAL CONSTRUCTION:

- ALUMINIZED STEEL

PAINT:

- HIGH TEMPERATURE BLACK (MIRATECH COATING SYSTEM 5)

PROJECT NAME	<p>PROPRIETARY AND CONFIDENTIAL</p> <p>THE INFORMATION CONTAINED IN THIS DRAWING IS THE SOLE PROPERTY OF MIRATECH GROUP, LLC. ANY REPRODUCTION IN PART OR AS A WHOLE WITHOUT THE WRITTEN PERMISSION OF MIRATECH GROUP, LLC IS PROHIBITED.</p>	DIMENSIONS ARE IN INCHES UNLESS OTHERWISE SPECIFIED			
PROPOSAL NUMBER		<small>DIMENSIONAL TOLERANCES UNLESS OTHERWISE SPECIFIED</small> ANGLES: MACH: ±1° INCHES: ±0.125 BEND: ±3° MILLIMETERS: ±2		<p align="center">JCEE0-04PF-1-00000000</p> <p align="center">Sales Drawing</p>	
SALES ORDER NO.		DO NOT SCALE DRAWING			
CUSTOMER P.O.		DRAWN JFS	DATE 08/08/2016	DRAWING JCEE0-04PF-1-00000000 SD	REV 0
		REVIEWED BY EQJ	DATE 08/19/2016	SIZE A	SCALE 1:12 WEIGHT: 81 lb SHEET 1 OF 1