

(2) 4" FF FLANGE  
150 lb ANSI  
STANDARD  
BOLT PATTERN

Ø 10.000  
SHELL  
I.D.

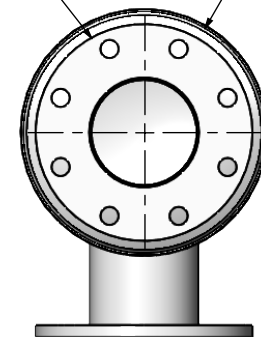

#### NOTES:

- DO NOT USE EQUIPMENT TO SUPPORT OTHER PARTS OF THE EXHAUST SYSTEM WITHOUT PROPER REINFORCEMENT

#### MATERIAL CONSTRUCTION:

- 304 STAINLESS STEEL

#### PAINT:

- NONE

PROJECT NAME

PROPOSAL NUMBER

SALES ORDER NO.

CUSTOMER P.O.

#### PROPRIETARY AND CONFIDENTIAL

THE INFORMATION CONTAINED IN THIS DRAWING IS THE SOLE PROPERTY OF MIRATECH GROUP, LLC. ANY REPRODUCTION IN PART OR AS A WHOLE WITHOUT THE WRITTEN PERMISSION OF MIRATECH GROUP, LLC IS PROHIBITED.

DIMENSIONS ARE IN INCHES  
UNLESS OTHERWISE SPECIFIED

DIMENSIONAL TOLERANCES UNLESS OTHERWISE SPECIFIED  
ANGLES:  
MACH: ±1°  
BEND: ±3°  
INCHES: ±0.125  
MILLIMETERS: ±2

DO NOT SCALE DRAWING

DRAWN JFS DATE 08/08/2016

REVIEWED BY EQJ DATE 08/19/2016



**JIGE0-04PF-3-0000001K**  
**Sales Drawing**

DRAWING	JIGE0-04PF-3-0000001K SD	REV 0
SIZE A	SCALE 1:8	WEIGHT: 48 lb
SHEET 1 OF 1		