

EXHAUST FLOW

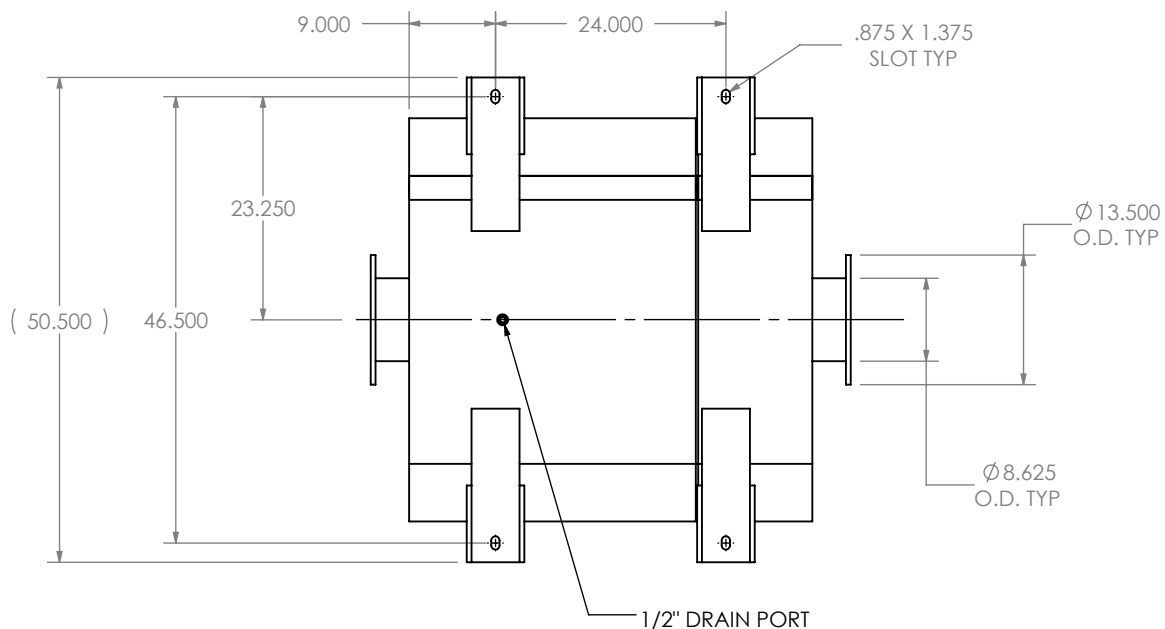

NOTES:

- DO NOT USE EQUIPMENT TO SUPPORT OTHER PARTS OF THE EXHAUST SYSTEM WITHOUT PROPER REINFORCEMENT

MATERIAL CONSTRUCTION:

- CARBON STEEL

PAINT:

- HIGH TEMPERATURE BLACK (MIRATECH COATING SYSTEM 5)

| | |
|-----------------|--|
| PROJECT NAME | |
| PROPOSAL NUMBER | |
| SALES ORDER NO. | |
| CUSTOMER P.O. | |

PROPRIETARY AND CONFIDENTIAL

THE INFORMATION CONTAINED IN THIS DRAWING IS THE SOLE PROPERTY OF MIRATECH GROUP, LLC. ANY REPRODUCTION IN PART OR AS A WHOLE WITHOUT THE WRITTEN PERMISSION OF MIRATECH GROUP, LLC IS PROHIBITED.

| | |
|---|-----------------|
| DIMENSIONS ARE IN INCHES UNLESS OTHERWISE SPECIFIED | |
| DIMENSIONAL TOLERANCES UNLESS OTHERWISE SPECIFIED | |
| ANGLES: | |
| MACH: ±1* | INCHES: ±0.125 |
| BEND: ±3* | MILLIMETERS: ±2 |
| DO NOT SCALE DRAWING | |
| DRAWN | DATE |
| FES | 9/16/2016 |
| REVIEWED BY | DATE |
| AJM | 09/30/2016 |

| | | | |
|---|---|---------------------------|--------|
| | | | |
| OCEE0B-08PF-2-00000000 Sales Drawing | | | |
| DRAWING | | OCEE0B-08PF-2-00000000 SD | |
| REV | 0 | SCALE | 1:20 |
| SIZE | A | WEIGHT | 312 lb |
| | | SHEET 1 OF 1 | |