

(2) 6" FF FLANGE  
150 lb ANSI  
STANDARD  
BOLT PATTERN

Ø 12.000  
SHELL I.D.

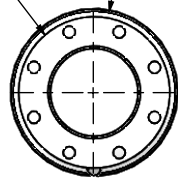

FRONT VIEW

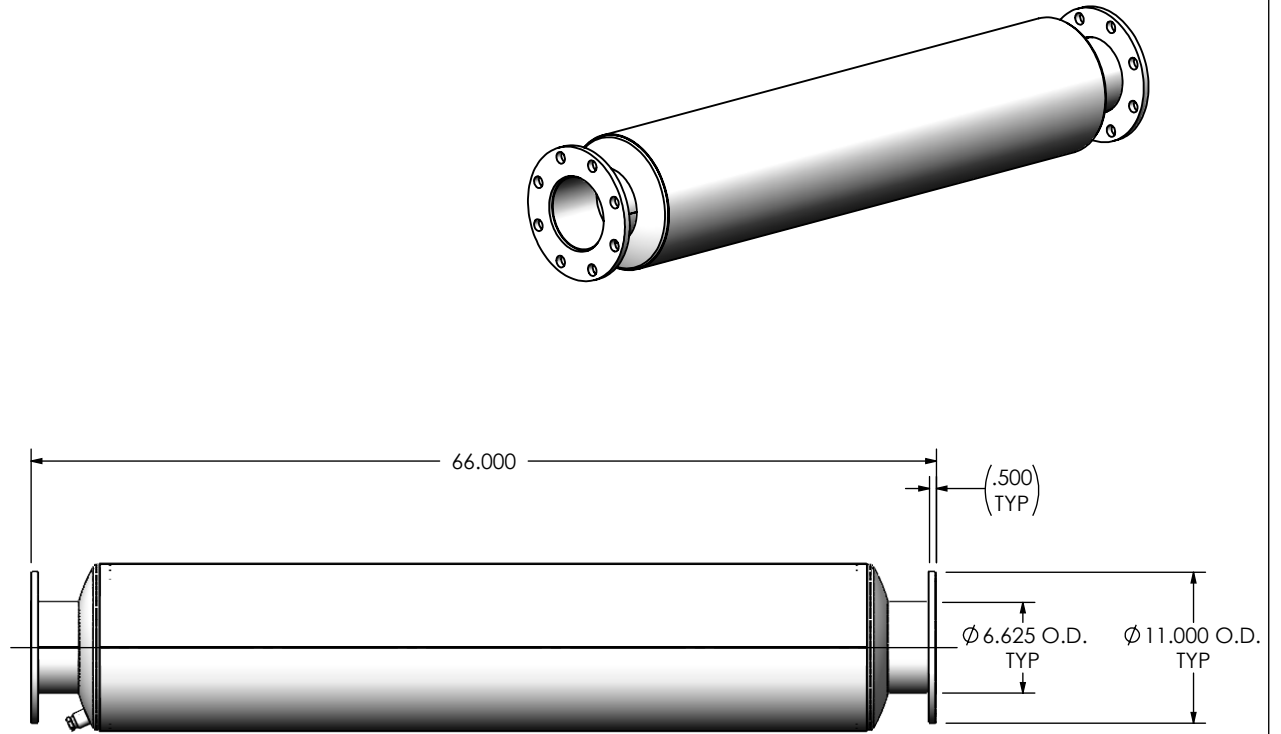

RIGHT VIEW



**NOTES:**

- DO NOT USE EQUIPMENT TO SUPPORT OTHER PARTS OF THE EXHAUST SYSTEM WITHOUT PROPER REINFORCEMENT

**MATERIAL CONSTRUCTION:**

- ALUMINIZED STEEL

**PAINT:**

- HIGH TEMPERATURE BLACK (MIRATECH COATING SYSTEM 5)

PROJECT NAME

PROPOSAL NUMBER

SALES ORDER NO.

CUSTOMER P.O.

**PROPRIETARY AND CONFIDENTIAL**

THE INFORMATION CONTAINED IN THIS DRAWING IS THE SOLE PROPERTY OF MIRATECH GROUP, LLC. ANY REPRODUCTION IN PART OR AS A WHOLE WITHOUT THE WRITTEN PERMISSION OF MIRATECH GROUP, LLC IS PROHIBITED.

DIMENSIONS ARE IN INCHES  
UNLESS OTHERWISE SPECIFIED

ANGLES:  
MACH: ±1°  
BEND: ±3°

INCHES: ±0.125  
MILLIMETERS: ±2

DO NOT SCALE DRAWING

DRAWN FES DATE 10/07/2016

REVIEWED BY AJM DATE 10/14/2016



**TCEEP-06PF-1-00000000**  
**Sales Drawing**

DRAWING		TCEEP-06PF-1-00000000 SD		REV 0
SIZE A	SCALE 1:14	WEIGHT: 110.3081 lb	SHEET 1 OF 1	