

(2) 10" FF FLANGE
150 lb ANSI
STANDARD
BOLT PATTERN

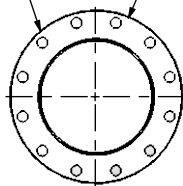

FRONT VIEW

Ø 16.000
SHELL I.D.

1/2" NPT
DRAIN PORT

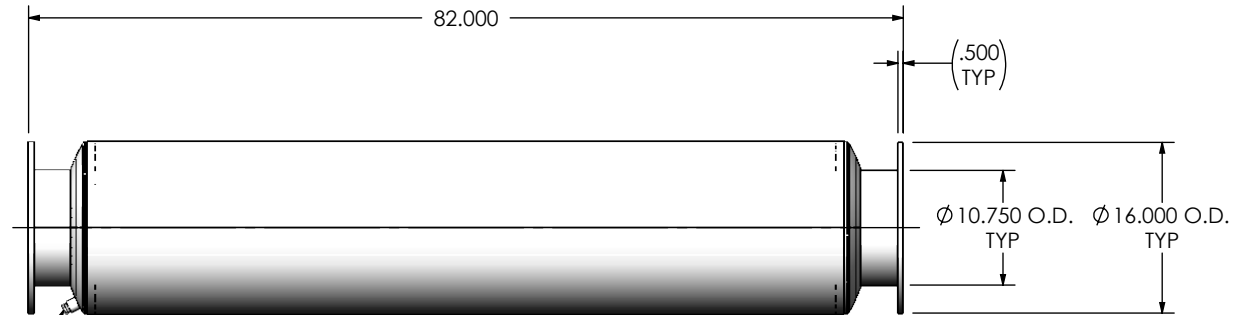

RIGHT VIEW

EXHAUST FLOW

NOTES:

- DO NOT USE EQUIPMENT TO SUPPORT OTHER PARTS OF THE EXHAUST SYSTEM WITHOUT PROPER REINFORCEMENT

MATERIAL CONSTRUCTION:

- 304 STAINLESS STEEL

PAINT:

- NONE

PROJECT NAME

PROPOSAL NUMBER

SALES ORDER NO.

CUSTOMER P.O.

PROPRIETARY AND CONFIDENTIAL

THE INFORMATION CONTAINED IN THIS DRAWING IS THE SOLE PROPERTY OF MIRATECH GROUP, LLC. ANY REPRODUCTION IN PART OR AS A WHOLE WITHOUT THE WRITTEN PERMISSION OF MIRATECH GROUP, LLC IS PROHIBITED.

DIMENSIONS ARE IN INCHES
UNLESS OTHERWISE SPECIFIED

ANGLES: ±1°
MACH: ±0.005
BEND: ±3°
INCHES: ±0.125
MILLIMETERS: ±2

DO NOT SCALE DRAWING

DRAWN: FES
DATE: 10/07/2016

REVIEWED BY: AJM
DATE: 10/14/2016



TCEEP-12PF-3-00000000
Sales Drawing

DRAWING	TCEEP-12PF-3-00000000 SD	REV 0
SIZE A	SCALE 1:18	WEIGHT: 200.1527 lb
SHEET 1 OF 1		