

(2) 18" FF FLANGE
150 lb ANSI
STANDARD
BOLT PATTERN

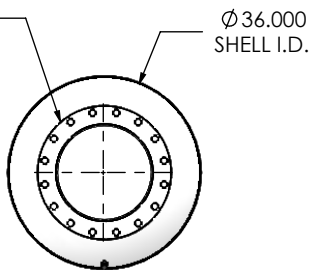

FRONT VIEW

Ø 36.000
SHELL I.D.

1/2" NPT
DRAIN PORT

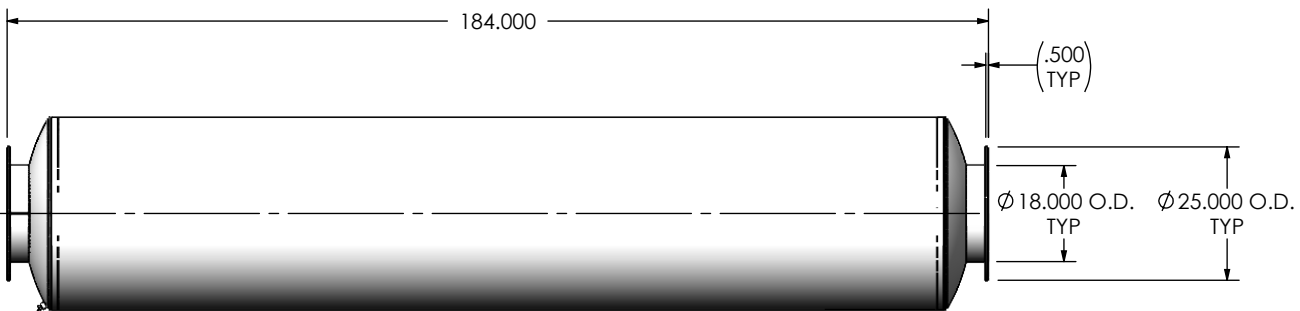

RIGHT VIEW



NOTES:

- DO NOT USE EQUIPMENT TO SUPPORT OTHER PARTS OF THE EXHAUST SYSTEM WITHOUT PROPER REINFORCEMENT

MATERIAL CONSTRUCTION:

- 304 STAINLESS STEEL

PAINT:

- NONE

PROJECT NAME	<p>PROPRIETARY AND CONFIDENTIAL</p> <p>THE INFORMATION CONTAINED IN THIS DRAWING IS THE SOLE PROPERTY OF MIRATECH GROUP, LLC. ANY REPRODUCTION IN PART OR AS A WHOLE WITHOUT THE WRITTEN PERMISSION OF MIRATECH GROUP, LLC IS PROHIBITED.</p>
PROPOSAL NUMBER	
SALES ORDER NO.	
CUSTOMER P.O.	

DIMENSIONS ARE IN INCHES UNLESS OTHERWISE SPECIFIED	
DIMENSIONAL TOLERANCES UNLESS OTHERWISE SPECIFIED	
ANGLES:	
MACH: ±1"	INCHES: ±0.125
BEND: ±3"	MILLIMETERS: ±2
DO NOT SCALE DRAWING	
DRAWN	DATE
FES	10/07/2016
REVIEWED BY	DATE
AJM	10/14/2016

<p>TCEEP-18PF-3-00000000 Sales Drawing</p>			
DRAWING		REV	
TCEEP-20PF-3-00000000 SD		0	
SIZE	SCALE 1:36	WEIGHT: 886.2776 lb	SHEET 1 OF 1
A			