

(2) 24" FF FLANGE  
150 lb ANSI  
STANDARD  
BOLT PATTERN

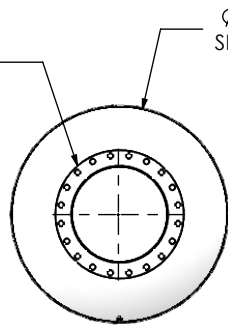

FRONT VIEW

Ø 54.000  
SHELL I.D.

1/2" NPT  
DRAIN PORT

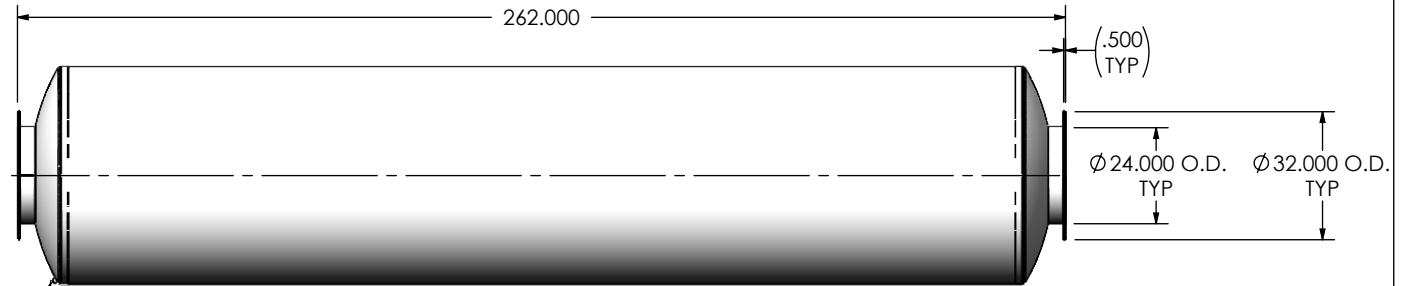

RIGHT VIEW



**NOTES:**

- DO NOT USE EQUIPMENT TO SUPPORT OTHER PARTS OF THE EXHAUST SYSTEM WITHOUT PROPER REINFORCEMENT

**MATERIAL CONSTRUCTION:**

- 304 STAINLESS STEEL

**PAINT:**

- NONE

PROJECT NAME
PROPOSAL NUMBER
SALES ORDER NO.
CUSTOMER P.O.

**PROPRIETARY AND CONFIDENTIAL**

THE INFORMATION CONTAINED IN THIS DRAWING IS THE SOLE PROPERTY OF MIRATECH GROUP, LLC. ANY REPRODUCTION IN PART OR AS A WHOLE WITHOUT THE WRITTEN PERMISSION OF MIRATECH GROUP, LLC IS PROHIBITED.

DIMENSIONS ARE IN INCHES UNLESS OTHERWISE SPECIFIED

DIMENSIONAL TOLERANCES UNLESS OTHERWISE SPECIFIED	
ANGLES:	
MACH: ±1"	INCHES: ±0.125
BEND: ±3°	MILLIMETERS: ±2

DO NOT SCALE DRAWING

DRAWN	DATE
FES	10/07/2016
REVIEWED BY	DATE
AJM	10/14/2016

<p><b>TCEEP-24PF-3-00000000</b> Sales Drawing</p>			
DRAWING		TCEEP-24PF-3-00000000 SD	
REV	0	SCALE	1:48
SIZE	A	WEIGHT	2797.5662 lb
		SHEET 1 OF 1	