

(2) 22" FF FLANGE
150 lb ANSI
STANDARD
BOLT PATTERN

[1372]
Ø 54"
NOM DIA

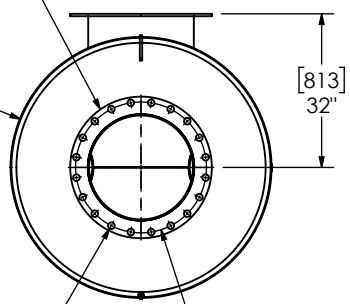

[813]
32"

([35])
Ø 1 3/8"
TYP

([692])
Ø 27 1/4"
BCD

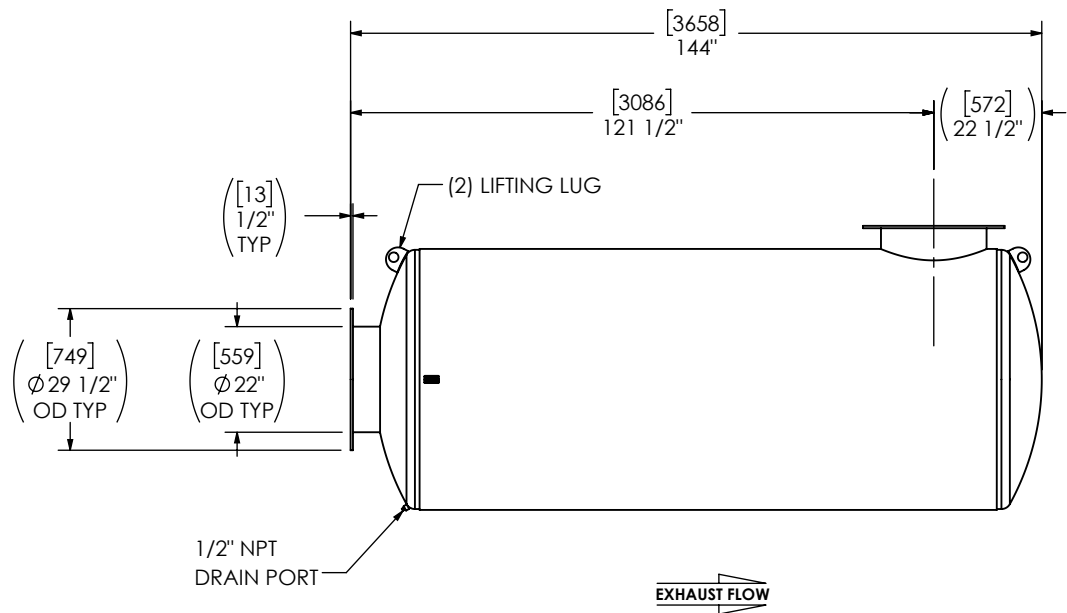

- NOTES:**
- DO NOT USE EQUIPMENT TO SUPPORT OTHER PARTS OF THE EXHAUST SYSTEM WITHOUT PROPER REINFORCEMENT
- MATERIAL CONSTRUCTION:**
- CARBON STEEL
- PAINT:**
- HIGH TEMPERATURE BLACK (MIRATECH COATING SYSTEM 5)

PROJECT NAME	PROPRIETARY AND CONFIDENTIAL THE INFORMATION CONTAINED IN THIS DRAWING IS THE SOLE PROPERTY OF MIRATECH. ANY REPRODUCTION IN PART OR AS A WHOLE WITHOUT THE WRITTEN PERMISSION OF MIRATECH IS PROHIBITED.	ALL DIMENSIONS IN INCHES (MILLIMETERS) UNLESS OTHERWISE SPECIFIED.			
PROPOSAL NUMBER		CRITICAL DIMENSIONS ARE CIRCLED			
SALES ORDER NO.		TOLERANCES UNLESS OTHERWISE SPECIFIED < 12 [305] ±1/8 [3] 12 [305] ≥ 36 [915] ±3/16 [5] 36 [915] ≥ 360 [9150] ±5/16 [9] > 360 [9150] ±7/16 [12] ANGULAR ±3° WEIGHT ±10%	M3EA0-22PF-2-00005D2V SILENCER CRITICAL GRADE M32		
CUSTOMER P.O. [P.N.]		PROJECTION 	SALES DRAWING M3EA0-22PF-2-00005D2V SD	OEM NO	REV 0
		DRAWN SVP DATE 2024-01-19 REVIEWED CSF DATE 2024-01-19	SIZE A DO NOT SCALE	SCALE 1:40 WEIGHT 2012lb/914kg	SHEET NO. 1 OF 1