

(2) 6" FF FLANGE
150 lb ANSI
STANDARD
BOLT PATTERN

[559]
Ø 22"
NOM DIA

[22]
Ø 7/8"
TYP

[241]
Ø 9 1/2"
BCD

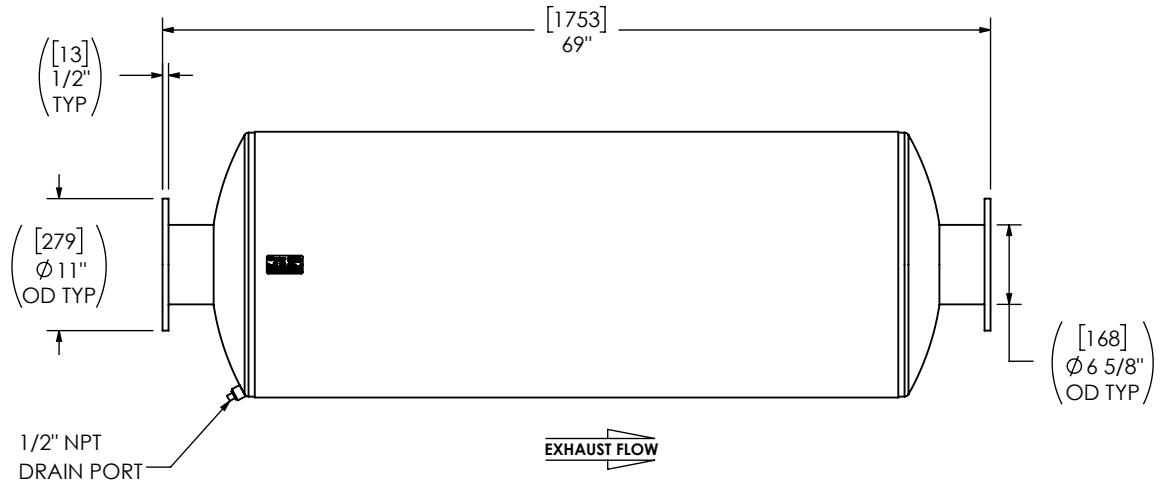
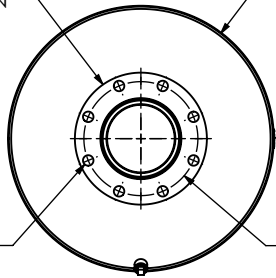

NOTES:

- DO NOT USE EQUIPMENT TO SUPPORT OTHER PARTS OF THE EXHAUST SYSTEM WITHOUT PROPER REINFORCEMENT

MATERIAL CONSTRUCTION:

- CARBON STEEL

PAINT:

- HIGH TEMPERATURE BLACK (MIRATECH COATING SYSTEM 5)

PROJECT NAME	PROPRIETARY AND CONFIDENTIAL THE INFORMATION CONTAINED IN THIS DRAWING IS THE SOLE PROPERTY OF MIRATECH. ANY REPRODUCTION IN PART OR AS A WHOLE WITHOUT THE WRITTEN PERMISSION OF MIRATECH IS PROHIBITED.	ALL DIMENSIONS IN INCHES (MILLIMETERS) UNLESS OTHERWISE SPECIFIED.				
PROPOSAL NUMBER		CRITICAL DIMENSIONS ARE CIRCLED				
SALES ORDER NO.		TOLERANCES UNLESS OTHERWISE SPECIFIED < 12 [305] ±1/8 [3] 12 [305] ≥ 36 [915] ±3/16 [5] 36 [915] ≥ 360 [9150] ±5/16 [9] > 360 [9150] ±7/16 [12]	MT2EE0-06PF-2-00000000 SILENCER RESIDENTIAL GRADE MT42			
CUSTOMER P.O. [P.N.]		PROJECTION 	DRAWN AB DATE 2024-09-19 REVIEWED CSF DATE 2024-09-19	SALES DRAWING MT2EE0-06PF-2-00000000 SD	OEM NO 0 REV 0	
		SIZE A	DO NOT SCALE	SCALE 1:16	WEIGHT 178lb/80kg	SHEET NO. 1 OF 1